



**ROBERT E. PARILLA
PERFORMING ARTS CENTER**

**TECHNICAL SPECIFICATIONS
&
THEATRE INFORMATION**

Venue Contact Information

THEATRE MANAGER	DEBRA FYODOROV	OFFICE:	240-567-7536 EMAIL: DEBRA.FYODOROV@MONTGOMERYCOLLEGE.EDU
PROGRAM ASSISTANT	JIM TERRY	OFFICE:	240-567-7537 EMAIL: JIM.TERRY@MONTGOMERYCOLLEGE.EDU
BOX OFFICE MANAGER	PHILLIP PURYEAR	OFFICE:	240-567-5301 EMAIL: PHILLIP.PURYEAR@MONTGOMERYCOLLEGE.EDU
PUBLICIST	ANGIE LOCKHART	OFFICE:	240-567-7538 EMAIL: ANGIE.LOCKHART@MONTGOMERYCOLLEGE.EDU
PRODUCTION ASSISTANT	CHERYL SWISS	OFFICE:	240-567-7170 EMAIL: CHERYL.SWISS@MONTGOMERYCOLLEGE.EDU
THEATRE TECHNICIAN	MIKE WATSON	OFFICE:	240-567-8075 EMAIL: MICHAEL.WATSON@MONTGOMERYCOLLEGE.EDU
THEATRE TECHNICIAN	CARL SHORTER	OFFICE:	240-567-7544 EMAIL: CARL.SHORTER@MONTGOMERYCOLLEGE.EDU
THEATRE TECHNICIAN	MATTHEW WEESE	OFFICE:	240-567-8076 EMAIL: MATTHEW.WEESE@MONTGOMERYCOLLEGE.EDU
THEATRE FAX #		FAX:	240-567-7542 WEBSITE: WWW.MONTGOMERYCOLLEGE.EDU/PAC

Mailing & Venue / Campus Address:

Robert E. Parilla Performing Arts Center
Montgomery College: Rockville Campus
51 Mannakee Street
Rockville, Maryland 20850-1195 USA.

***Shipping Address* (FED EX & UPS)**

Montgomery College
Central Receiving
Attn: Performing Arts Center
7602 Standish Way
Rockville, Maryland 20855 USA

***Central Receiving is NOT located on Campus! Items shipped to the college without notice are refused. ***

MAP & DIRECTIONS:

Airports closest:

IAD / Dulles International @ 29.4 miles

DCA / Reagan National @ 28.6 miles

BWI / Baltimore Washington International @ 42.5 miles

Driving:

From the north: Take I-270 South to Exit 6 (Route 28), W. Montgomery Ave./Rockville. Then take Exit 6A (Route 28) East. Turn left at first traffic light onto Nelson Street. Go to first traffic light at Mannakee Street; turn left. The campus is 1-1/2 blocks on the left. **TRUCKS:** Bypass Nelson Street and take Route 28 to Route 355 and turn LEFT and follow to Mannakee Street.

From the south: Take I-495 to I-270 North exit 6A (Route 28, W. Montgomery Avenue/Rockville). Follow Montgomery College sign through traffic light (road becomes Nelson Street). Go to first traffic light at Mannakee Street; turn left. The campus is 1-1/2 blocks on the left.

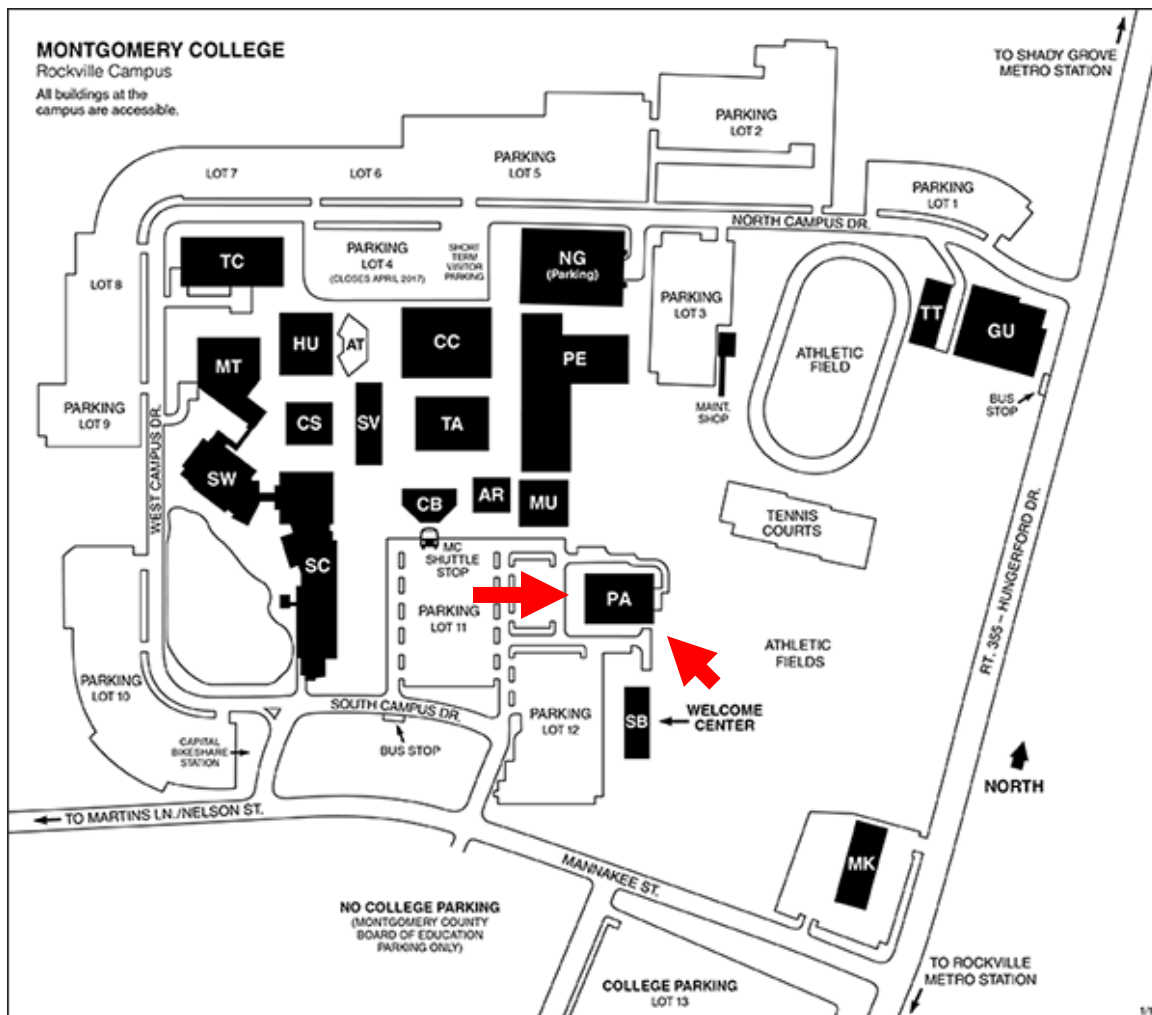

Backstage Theater Layout

1st Floor/ Street level

Note: Stage Dimensions page 5 – 7

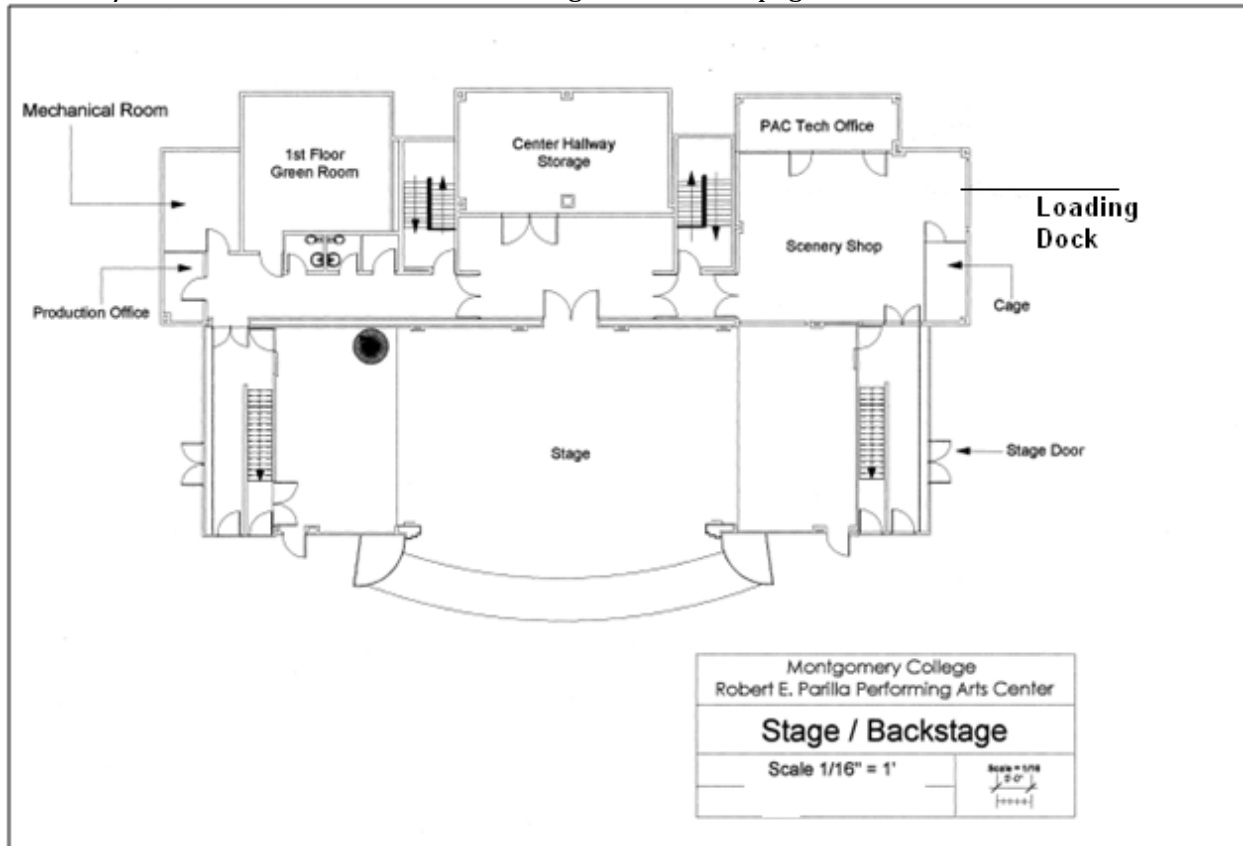

2nd Floor Level (above 1st floor Center Hallway Storage)

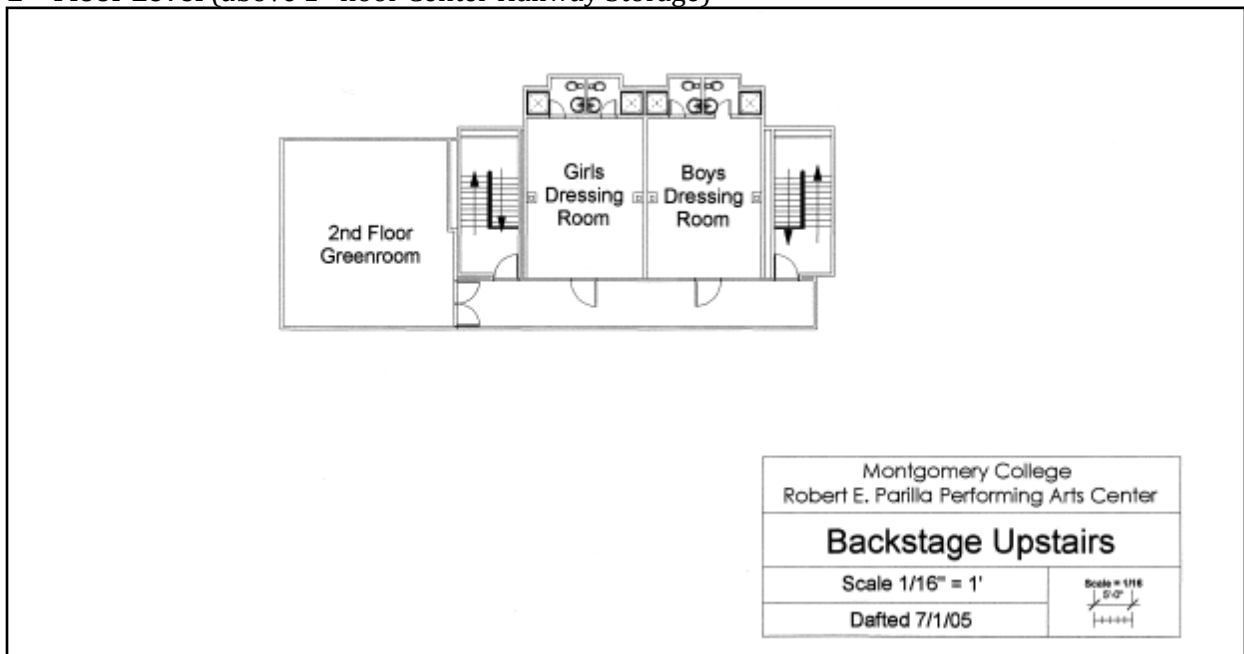

Note: Dressing Room / Green Room Details & Capacity on Page 13-14

Venue Information

Summary Description of Venue & Operations: The Center is a professional event venue with full-time professional staffing. **We do not staff or crew professional events with college students at the Center.** We are a professional non-union “road house” that is extremely flexible in its ability to host local community events, full industrials, touring concerts, ballet & opera tours to major theater tours. A state of the art production facility featuring continental seating; a stage thrust apron extended over the orchestra pit beyond the proscenium for additional room; 55’ grid-to-stage fly tower space, and industry current Lighting, Sound and Video systems. **Equipment and amenities are listed for The Guest Artist Series only. Equipment for Rentals and College users are on an as needed basis.**

Stage & House

LOADING DOCK DOOR HEIGHT: 10’ WIDTH: 9’9” (DOOR ADJACENT TO SCENE SHOP)

**LOADING DOOR IS AT STREET AND STAGE LEVEL. NO TRUCK-HEIGHT DOCK & NO FORK LIFT ON SITE. **

LOADING DOOR FROM THE SCENE SHOP TO THE STAGE HEIGHT: 16’ WIDTH: 9’11’

**TWO TRACTOR TRAILER-SIZED TRUCKS, OR ONE TOUR BUS AND ONE TRUCK, CAN BACK INTO THE LOADING AREA AT THE SAME TIME, SIDE BY SIDE. DISTANCE FROM DOCK TO STAGE: 45’ STRAIGHT PUSH. **

STAGE: 40’ WIDE X 26’ DEEP (NOT INCLUDING APRON OR WINGS)

STAGE DOOR: LOCATED NEXT TO LOADING DOCK	THEATER: PROSCENIUM STYLE W/ CURVED APRON
CAPACITY SEATING: 509 CONTINENTAL-STYLE ARRANGEMENT; AISES ON SIDES ONLY. NO CENTER AISLE.	*CONTROL / BOOTH: ELEVATED OPEN BOOTH @ REAR OF HOUSE ON 2 ND FLOOR; BOOTH 80’ x 12’ CURVED; PARTIALLY ENCLOSED
ORCHESTRA PIT: YES, UNDER STAGE APRON	BACKSTAGE HALLWAY DOORS: DOUBLE-WIDE, NO DIVIDER, 6’6” HIGH X 5’0” WIDE CLEARANCE
PARKING: AMPLE BY FACILITY	YEAR BUILT: 1984
HEIGHT OF PROSCENIUM OPENING: 19’ 2”	WIDTH OF PROSCENIUM OPENING: 40’0”
MAX DEPTH PLASTER LINE / MAIN ACT / FIRE CURTAIN TO BACK WALL: 27’ 0” APPROX	CENTER OF STAGE APRON THRUST DEPTH TO PLASTER LINE: 14’ 6” APPROX
WING SPACE STAGE LEFT AND RIGHT: 28’ US-DS x 15’ WIDE L-R	DISTANCE STAGE LEFT WALL TO STAGE RIGHT WALL: 82’ 6”
CENTER OF STAGE APRON TO BACK WALL: 42’	DISTANCE STAGE TO OPEN TECHNICAL BOOTH: 85’ (BOOTH REAR ABOVE ON 2 ND FLOOR)
ACOUSTICAL DESIGN OR TREATMENT: YES	ELEVATORS: NONE

TOURING MIX POSITION: 75’ DIRECT TO STAGE FROM MIX, AT AUDIENCE SEATING LEVEL. TOURING HOUSE MIX POSITION LOCATED AT REAR OF HOUSE, AREA IS 6’ X 12’ WITH A 2’ OVERHANG BEHIND SEATING AREA.

*A SMALL CABLE TROUGH LOCATED IN THE BACK OF THE HOUSE WITH 2 SEPARATE 20AMP CIRCUITS. THESE CIRCUITS ARE GROUNDED TO HOUSE AUDIO POWER PANELS. BACK STAGE CABLE PASS-THRU DOORS TO FOH LOCATED ON STAGE LEFT AND STAGE RIGHT. **CABLE PATH RUNS UP THROUGH BOOTH TO REAR OF FOH AND DOWN. APPROX. 150 FEET FOR SNAKE OR VIDEO CABLE RUN FROM STAGE. SL WING TO SR WING CABLE RUNS ALONG APRON – 75’.***

STAGE FLOOR

- STAGE FLOOR IS A RESILIENT, SPRUNG DANCE FLOOR WITH 1/2" BIRCH A/B PLYWOOD COVERING, PAINTED FLAT BLACK
- THERE ARE THREE (3) FLOOR-TRAPDOOR SECTIONS - ONE 4' WIDE X 16' DEEP AT CENTER & TWO SMALLER 4' WIDE X 8' DEEP AT QUARTER-LINES (10' OFF CENTER).
- PIT AND ORCH. AREA BELOW STAGE APPROX. 12'-16 DEEP W/ RAKED TILED CEILINGS.
- RESILIENT STAGE FLOOR IS 50' WIDE X 27'6 DEEP - REMAINDER OF STAGE WINGS ARE CONCRETE LEVEL TO FLOOR.
- CROSS-OVER LOCATED IN BACKSTAGE HALLWAY BEHIND STAGE.
- CABLE PATHS FROM BACKSTAGE TO FOH ON SL AND SR.

HOUSE STAGING & ACCESSORIES INVENTORY

#	DESCRIPTION	#	DESCRIPTION
60	WENGER BLACK CLOTH MUSICIAN CHAIRS	40	WENGER BLACK MUSIC STANDS
8	Z-TRUCK ROLLING COSTUME RACKS	4	WENGER 4' X 8' X 8" BAND RISERS
1	CONDUCTOR PLATFORM - 4' X 4' X 12"	4	WENGER 4' X 8' X 16" BAND RISERS
1	STEINWAY 9' CONCERT GRAND PIANO W/ BENCH	4	WENGER 4' X 8' X 24" BAND RISERS
1	PRODUCTION HOUSE TABLE	1	WENGER FULL STAGE ORCHESTRA SHELL SYSTEM*
6	WERNER LADDERS IN 6', 8' AND 12' (2 EACH)	5	50' PANELS- HARLEQUIN CASCADE DANCE FLOOR*
3	18' DOUBLE BAR - BALLET BARRES	2	SPEAKERS LECTERN / PODIUMS, MAHOGANY RED
1	GENIE BATTERY POWERED GENIE-LIFT 22' MAX (GENIE AWP-25s)	1	GENIE DRIVABLE SCISSOR LIFT 25' MAX (GENIE GS-1930)

ORCHESTRA PIT DIMENSIONS

44'6" WIDE X 17'8" DEEP CURVED WITH RAKED CEILING. PIT FLOOR LEVEL IS 12' BELOW STAGE, CEILING IS RAKED ANGLE TOWARDS AUDIENCE, WITH SLOPE FROM 10' RAKED DOWN TO 6'10" AT REAR OF PIT. COMFORTABLE CAPACITY IS 35 MUSICIANS & CONDUCTOR.

- **THE ORCHESTRA PIT APRON IS NOT A LIFT, IT IS A PARTIAL-WEIGHT-BEARING COVER** WHICH IS REMOVABLE IN ELEVEN 4' WIDE X 6' DEEP SECTIONS, 10" THICK STEEL & WOOD, EACH REQUIRING 4 PERSONS TO MOVE.
- PIT WHEN OPEN: 12' DOWN FROM STAGE DECK TO PIT FLOOR.
- PLATFORMS TO RAISE CONDUCTOR TO AN APPROPRIATE HEIGHT TO VIEW THE STAGE CAN BE INSTALLED **ONLY WITH ADVANCED NOTICE**. RISERS TO 'ELEVATE' ORCHESTRA ARE NOT ADVISED DUE TO RAKED CEILING.
- THERE IS **NO ELEVATOR** TO THE PIT. INSTRUMENTS MUST BE CARRIED DOWNSTAIRS OR BE LOWERED THRU THE STAGE TRAPS ON EQUIPMENT LIFT. TRAP DOOR 4'X8'EA.
- ORCHESTRA PIT CAN BE WIRED FOR SOUND AMPLIFICATION, INTERCOM OR PLAYBACK. AC POWER IS AVAILABLE IN 18 INDIVIDUAL 20 AMP CIRCUITS GROUNDED TO HOUSE AUDIO POWER. THERE IS NO IN-HOUSE VIDEO ABILITY FOR MONITOR OR CAMERA.
- A PIT NET EXISTS, CONSISTING OF AN ALUMINUM FRAME WITH A WEIGHT-BEARING TENSION WIRE GRID. **THE PIT NET MUST BE USED ANY TIME THE PIT COVERS ARE REMOVED, NO EXCEPTIONS!**

AUXILIARY STAGE POWER / TOURING POWER TIE-INS

STAGE RIGHT WALL COMPANY SWITCH (LIGHTING & MOTOR TIE-IN):

ONE (1) 400AMP SR INDEPENDENT 3- PHASE / 120/208v AC WYE DISCONNECT W/ FEMALE CAM-LOK CONNECTORS. GROUND & NEUTRAL CAMS ARE REVERSE

ONE (1) 100AMP INDEPENDENT 3-PHASE / 120/208v AC WYE CIRCUIT PANEL STAGE RIGHT W/10 BREAKER CIRCUIT L6-20 208V CONNECTIONS FOR MOVING LIGHTS. ONE SINGLE PHASE SET OF TAILS RUN TO A BULLET CONNECTOR FOR CHAIN MOTOR POWER DISTRIBUTION; LOCATED ON THE LOCK RAIL. HOUSE MOTOR POWER DISTRIBUTION & MOTION LABS CONTROL MAY BE USED UPON REQUEST.

STAGE LEFT WALL COMPANY SWITCH (AUDIO & STAGE TIE-IN):

ONE (1) 400AMP INDEPENDENT / 3-PHASE / 120/208V AC WYE DISCONNECT W/ CAM-LOK CONNECTORS, GROUND & NEUTRAL CAMS ARE REVERSED

AUXILIARY POWER COMPANY SWITCH (SCENE SHOP LOCATION):

ONE (1) 200AMP INDEPENDENT / 3-PHASE / 120/208V AC WYE DISCONNECT W/ CAM-LOK CONNECTORS, GROUND AND NEUTRAL CAMS ARE REVERSED

POWER ACCESSORIES AVAILABLE: 4 YELLOW-JACKET CABLE RAMPS. ONE (1) SET SINGLE-PHASE 10' CAM LOCK TAILS, 2/0 GAUGE; ONE 4-WIRE #6 TO CAM TAIL-SET & ONE 5-WIRE #2 TAIL-SET; CAM TAILS, CAM TEES, TURNAROUNDS AND ADDITIONAL FEEDER AVAILABLE WITH ADVANCED NOTICE ONLY.

SHORE POWER: ONE (1) L14-30 CONNECTOR TO A 30AMP BREAKER. LOCATED OUTSIDE DOCK. WE DO NOT PROVIDE ANY ADAPTORS OR CABLING.

STAGE RIGGING & FLY SYSTEM

GRID IRON HEIGHT: 48' HIGH PIPE TRIMS, 56' HEIGHT RIGGING OPTIONS FOR CHAIN MOTOR POINTS, ABOVE GRID RIGGING & HOUSE CHAIN MOTOR USE UPON ADVANCE NOTIFICATION ONLY. HOUSE FLY & HOUSE RIGGER OPERATION ONLY

SYSTEM: JR CLANCY DOUBLE PURCHASE COUNTER WEIGHT; ALL MANUAL OPERATION; 42 LINE-SETS, EXCLUDING MAIN DRAPE, EACH 6" APART.

LINE-SET PIPE DIAMETER: 1 1/2" o/d SCHEDULE 40	LINE-SET PIPE: LENGTH: 45' L
LEG PIPES: PIPE LENGTH: 56' L ELECTRICS: PIPE LENGTH: 45' L	LINE-SET PIPE: LOW TRIM: 4'6" H MAX HIGH TRIM: 48' 3/4" H
ELECTRICS: LOW TRIM: 5' HIGH TRIM: 34' (ELECTRIC CIRCUIT RACEWAYS & CABLES ARE FIXED, NOT MOVABLE)	LOCK RAIL LOCATION: 24' UP OFF STAGE FLOOR, LOCATED STAGE RIGHT.
ACCESS TO LOCK RAIL: SPIRAL STAIRCASE USR W/ SAFETY NET.	LOAD RAIL LOCATION: TOP OF TOWER, 50' FROM STAGE FLOOR; ACCESS STAGE RIGHT.

- ALL ROPE IN FLY SYSTEM IS NEW ENGLAND POLYESTER ROPE STAGE-SET x 3/4".
- SPOT LINES MAY BE TIED TO THE GRID IRON AS NEEDED.
- 21' TAB PIPES ARE AVAILABLE STAGE LEFT AND STAGE RIGHT, RUNNING UP AND DOWN-STAGE, AND ARE TIED OFF FROM THE PIN RAIL STAGE RIGHT.

ALL RIGGING, SETS & SOFT-GOODS ARE SUBJECT TO APPROVAL AND INSPECTION FROM HOUSE TECH STAFF PRIOR TO USE – NO EXCEPTIONS WILL BE MADE FOR SAFETY ISSUES.

NOTE: BACKDROP MINIMUM SIZES ARE 20' TALL x 40' WIDE; 22' x 44' RECOMMENDED. BACKDROP MAXIMUM IS 25' TALL TO ENABLE FULL FLY-OUT WITHOUT TRICK. STEEL 'BOTTOM-PIPE' IS AVAILABLE IN-HOUSE AND IS LIMITED IN 10', 4' AND 2' LENGTHS, WITH COUPLINGS.

ALL BACKDROPS & SOFT-GOODS OR OTHER MATERIALS MUST COME WITH FLAME RETARDANT TREATMENT & TEST CERTIFICATE OR PASS A SITE FLAME TEST AT OUR DISCRETION, OR IT IS NOT PERMITTED FOR USE.

HOUSE CURTAINS & SOFT-GOOD INVENTORY

DESCRIPTION	QUANTITY	HEIGHT	WIDTH	COLOR	SEWN	MATERIAL (SOFT-GOOD FABRICS = IFR TAGS)
LEGS	10	28'	12'	BLACK	FLAT	26 OZ. VELOUR IFR
BORDERS	5	10'	50'	BLACK	FLAT	25 OZ. VELOUR IFR
MAIN ACT CURTAIN	2 PANELS	24'	22'	REGAL	50% FULL	25 OZ. VELOUR, TRACK OR GUILLOTINE IFR
MID-STAGE BLACK	2 PANELS	24'	22'	BLACK	50% FULL	25 OZ. VELOUR, TRACK OR GUILLOTINE IFR
CYC BACK DROP	1	28'	44'	WHITE	FLAT	LENO FILLED SHARKS TOOTH
BLACK SCRIM	1	24'	44'	BLACK	FLAT	SHARKS TOOTH OPEN WEAVE IFR
BLACKOUT PANELS	2	24'	25'	BLACK	FLAT	25 OZ. VELOUR IFR

2017 House Line-set Schedule

LINE SET#	DESCRIPTION	PLASTER LINE 0'-0"	ARBOR CAPACITY	HOUSE WEIGHT	MAX LINE STEEL	NOTES:
01	MAIN ACT CURTAIN	1' 0"	-		-	NOT MOVABLE
02	1 ST BORDER (10'X 45')	1' 6"	70"	+10"ST	490	
03	1 ST LEG (8'X 28')	2' 0"	64"	+14"ST	448	
04	1ST ELECTRIC	3' 0"	80"		560	
05	OPEN	4' 0"	70"		490	
06	MAC 2K MOVING LIGHT PIPE #1	4' 6"	70"		490	# 1, 25, 49, 73, 97
07	MOVIE SCREEN	5' 0"	70"		490	
08	ORCHESTRA SHELL CEILING #1	5' 6"	-		-	NOT MOVEABLE
09	2 ND BORDER (10'X 45')	6' 6"	70"	+10"ST	490	
10	2 ND LEG (10'X28')	7' 0"	64"	+14" ST	448	
11	2ND ELECTRIC	8' 0"	80"		560	
12	OPEN	8' 6"	70"		490	
13	OPEN	10' 0"	70"		490	
14	OPEN	10' 6"	70"		490	
15	3 RD BORDER(10'X 45')	11' 0"	70"	+10"ST	490	
16	3 RD LEG (10'X28')	11' 6"	64"	+14" ST	448	
17	ORCHESTRA SHELL CEILING #2	12' 0"	-		-	NOT MOVEABLE
18	MAC 2K MOVING LIGHT PIPE #2	12' 6"	70"		490	# 121, 145, 169, 193, 217
19	OPEN	13' 0"	70"		490	
20	OPEN	13' 6"	70"		490	
21	MID-STAGE BLACK TRAVELER	14' 0"	58"		406	NOT MOVEABLE
22	OPEN	14' 6"	70"		490	
23	OPEN	15' 0"	70"		490	
24	4 TH BORDER (10'X 45')	15' 6"	70"	+10"ST	490	
25	4 TH LEG(10'X28')	16' 0"	64"	+14" ST	448	
26	3RD ELECTRIC	16' 6"	80"		560	
27	OPEN	17' 0"	70"		490	
28	OPEN	18' 0"	70"		490	
29	MAC 2K MOVING LIGHT PIPE #3	18' 6"	70"		490	# 241, 265, 289, 313, 337
30	ORCHESTRA SHELL CEILING #3	20' 0"	-		-	NOT MOVEABLE
31	5 TH BORDER (10'X 45')	20' 6"	70"	+10"ST	490	
32	BLACK SCRIM – IF AVAILABLE	21' 0"	70"	+16"- 24"	490	
33	5 TH LEG(10'X28')	21' 6"	64"	+14" ST	448	
34	4TH ELECTRIC	22' 6"	80"		560	
35	OPEN	23' 0"	70"		490	
36	OPEN	23' 6"	70"		490	
37	OPEN	24' 0"	70"		490	HOUSE TRUSS POSITION
38	OPEN	24' 6"	70"		490	HOUSE TRUSS POSITION
39	OPEN	25' 0"	70"		490	
40	OPEN	25' 6"	70"		490	
41	OPEN	26' 0"	70"		490	
42	BLACK OUT DROP (2X 25'X25')	26' 6"	70"		490	NOT MOVABLE
43	CYC-BOUNCE DROP	27' 0"				NOT MOVABLE
TOTAL COUNTERWEIGHT AVAILABLE: 17,912 LBS.			196 - 1" LEAD = 21 LBS. = 4,116 LBS.			
443 - 2" STEEL = 26 LBS = 11,518 LBS.			192 - 1" STEEL = 14 LBS. = 2,278 LBS.			

ELECTRICS: CONTROL, DIMMING & LIGHTING

HOUSE LIGHTING CONTROL: ETC UNISON SYSTEM, INDEPENDENT CONTROL FADER LOCATED IN THE BOOTH AND BACK STAGE RIGHT, OR PATCH THRU DMX512 TO CONSOLE CONTROL. PATCH DIMMERS 193-199 FOR HOUSE LIGHT.

STAGE LIGHTING CONSOLES: (1) ETC INSIGHT 3 WITH RFU RUNNING EXPRESSION V 3.03 SOFTWARE.

(1) GRANDMA 2 FULL SIZE CONSOLE, RUNNING THE LATEST SOFTWARE BUILD

(1) GRANMA 2 ONPC (COMMAND AND FADER WINGS), USED FOR CUEING, FOCUS, AND AS A BACKUP CONSOLE WITH THE LATEST BUILD.

**CURRENT HOUSE LIGHTING SYSTEM UTILIZES 4 UNIVERSES OF DMX.
ALL HOUSE CONSOLES ARE ON UPS REGULATED POWER BACK UP.**

(NOTE: WE HAVE OFFLINE EDITOR SOFTWARE FOR BOTH CONSOLES. PLEASE SEND US YOUR SHOW FILES PRIOR TO LOAD IN. FOR OTHER SHOW FILES: WE HAVE LIGHTWRIGHT 5; VECTORWORKS '09; PLUS AUTO-CAD/DWG READING ABILITY.)

NETWORKS AND WIRELESS DMX: THE VENUE HAS BOTH MA 2PORT NODES AND ETC NET 1 NODES AVAILABLE. THE CURRENT FUNCTIONING NETWORK IS MA NET, HOWEVER IT CAN BE EASILY SWITCHED BACK TO ETC NET 1 PROTOCOL. THERE ARE 13 NETWORK (CAT-5) PLUG-IN STATIONS LOCATED AROUND THE BUILDING, ALLOWING ACCESS TO THE CONTROL NETWORK (MA NET). WIRELESS SOLUTIONS WIRELESS DMX TRANSMITTERS AND RECEIVERS ARE AVAILABLE UPON REQUEST.

CONSOLE LOCATIONS: PRODUCTION BOOTH, WITH REMOTE FOCUS UNIT PORTS SR @ SM DESK & CATWALKS. LIGHTING CONSOLES **DO NOT MOVE**. HOWEVER, THE MA2 ONPC CAN BE SET UP AT ANY LOCATION IN THE BUILDING RUNNING IN SESSION WITH THE FULL SIZE VIA MA NET.

DIMMERS: TWO ETC SR96 DIMMER RACKS POPULATED WITH ONE HUNDRED NINETY-TWO (192) 2400WATT ETC SENSOR DIMMERS. D20 MODULES ONE DIMMER PER CIRCUIT IN 98% OF SYSTEM. CC20 (CONSTANT CIRCUIT MODULES) AVAILABLE UPON REQUEST FOR LED FIXTURES. CIRCUIT & RACEWAY CONNECTORS: ALL STANDARD 20AMP STAGE-PIN 2P&G. EACH DIMMER RACK IS CONNECTED TO ITS OWN 400AMP 208 VOLT ELECTRICAL PANEL, INDEPENDENT FROM ON-STAGE DISCONNECTS.

OF ELECTRIC RACEWAYS OVER STAGE: FOUR (4) RACEWAYS (4TH IS CYC LIGHTS ONLY). EACH RACEWAY WITH 24 DIMMER CIRCUITS & 1 REMOTE NON-DIM 20AMP 120V EDISON CIRCUIT, DMX FROM OPTI-ISO ALSO AVAILABLE THAT TERMINATE AT A SINGLE UNIVERSE OVER ALL ELECTRICS.

FRONT OF HOUSE LIGHTING POSITIONS: COVE AREA 44' CURVED X 2 LOCATIONS; 1 NEAR OVER APRON W/ 16 CIRCUITS, 1 FAR OVER SEATING W/ 24 CIRCUITS – ACCESS BY CATWALKS;

FOH 'BALCONY/RAIL-TYPE' POSITIONS: 2 FOH BOX-BOOM POSITIONS PER SIDE (FOR RAIL AND CURTAIN WARMER POSITION) 1 NEAR AND 1 FAR SL/SR, ON 2ND FLOOR WITH 8 CIRCUITS AND 4 CIRCUITS EACH RESPECTIVELY. NO CENTER RAIL AVAILABLE.

OF STAGE DECK FLOOR CIRCUITS: 17 CIRCUITS DISTRIBUTED AT DECK, 2 ON STAGE RIGHT WALL, 2 STAGE LEFT WALL AND 13 ON UPSTAGE REAR WALL

OF STAGE WING DROP BOXES (LIGHTING BOOMS): 5 BOXES PER STAGE SIDE, WITH 3 SEPARATE CIRCUITS & 1 DOUBLE CIRCUIT PER BOX. NOTE: 5TH DROP BOX CIRCUITS DOUBLE IN 1ST FOH BOX BOOM POSITION.

FOLLOW-SPOTS: TWO LYCIAN SUPERSTAR SHORT 1274 (1200 WATT HMI DOUBLE ENDED LAMP) IN FIXED SPOT POSITIONS IN BOOTH. NOT MOVABLE.

LIGHTING & FIXTURE INVENTORY

DESCRIPTION	QTY	SIZE	MISC	DESCRIPTION	QTY	SIZE	MISC
ETC SOURCE-4 19°	16	19°	750w	MARTIN MAC 500SP	4	23.5°	575MSR
ETC SOURCE-4 26°	55	26°	750w	MARTIN MAC 600NT	4	WASH	575MSR
ETC SOURCE-4 36°	51	36°	750w	MARTIN MAC 2000 PERFORMANCE UNITS	19		1200WATT
ETC SOURCE-4 50°	20	50°	750w	MORPHEUS M-FADER CMY SCROLLERS	30	6.25"/ 8"/ 10"	
ETC SOURCE-4 PARS	42	ALL	750w	MORPHEUS PS-6 M-FADER PSU (6 WAY)	8		
STRAND FRESNEL	34	6"	750w	LE MAITRE RADIANCE HAZER w/ DMX FAN	1		TOUR PACK
STRAND FRESNEL	24	8"	1000w	ETC SOURCE -4 IRIS	12	REG	
COLORTAN FAR-CYC (NOT USED)	6	3-CELL PAN CYC	1000w	ETC GOBO HOLDERS	40	B SIZE	
PHILIPS SELECON PLCYC1 MKII LED CYC LIGHT	12	1-CELL PAN CYC	140 WATT MAX	SIDE ARMS FLOOR BASES	36 6	12"-18" 5LB	
SHOWLINE SL BAR 660 RGBW LED GROUND ROW	7	36 INV LED CELL	750 WATT MAX	SCHEDULE 40 PIPE	10	10' HIGH	
LYCIAN SUPERSTAR 1274	2	SHORT	1200w	50 LB. BASES	10		
ETC NET 1 NODES	6			WIRELESS SOLUTIONS TRANSMITTERS	2	SINGLE UNIVERSE	
MA 2 PORT NODES	2			WIRELESS SOLUTIONS RECEIVERS	6	2 DMX OUT PUTS	

THE VENUE IS FULLY STOCKED WITH ALL DMX, STAGE PIN, EDISON, SOCA, AND POWER CON CABLES. FOR A COMPLETE INVENTORY PLEASE CONTACT THE THEATER TECHNICIANS.

STAGE RUNNING LIGHTS PERMANENTLY ATTACHED TO THE WALLS IN THE WINGS, BOOTH & BACKSTAGE AREAS. THESE ARE BLUE LED'S AND ARE ALWAYS-ON.

UNLESS ARRANGED FOR IN CONTRACT & TIME, ALL USER GROUPS MUST UTILIZE THE HOUSE PLOT AS-IS WITH NO CHANGES TO COLOR OR FOCUS ALLOWED. OUR HOUSE PLOT IS A VERSATILE FLEXIBLE LIGHTING PLOT THAT PROVIDES FOR SPECIALS, GOBO'S, CENTER & QUARTER LINE SPOTS UPSTAGE TO DOWN, MULTIPLE TOP, FRONT AND SIDE COLOR WASHES & ISOLATION AREAS TO ACCOMMODATE MOST DANCE, THEATER AND MUSIC EVENTS EASILY.

VIDEO & PROJECTION

SCREENS: TWO SCREEN SIZES ARE AVAILABLE:

ONE (1) 162" x 288" (13'6" x 24') DRAPER FLOWN BLACK SCREEN WITH FRONT PROJECTION, BORDERED SKIN ONLY. THIS SCREEN IS BEST FOR FEATURE FILMS.

ONE (1) 144" x 192" (12' x 16') DRAPER FLOWN BLACK SCREEN WITH FRONT AND REAR PROJECTION, BORDERED SKIN.

NO DRESS KITS ARE AVAILABLE. ALL SCREENS ARE NOT MOTORIZED AND MUST BE FLOWN USING THE HOUSE MANUAL FLY SYSTEM.

PROJECTOR:

ONE (1) DIGITAL PROJECTION TITAN QUAD 2000 1080P 3D PROJECTOR. THE PROJECTOR IS 20,000 LUMENS AND HAS THE CAPACITY TO BE 2000:1 CONTRAST RATIO. THERE ARE FOUR (1) 465 WATT LAMPS. THE LENSE IS FIXED AND OPTIMIZED FOR THE VENUE.

SYSTEM:

THE SYSTEM RUNS THROUGH A CRESTRON PROCESSING UNIT, BUT THE POSSIBILITY TO SCALE AND SWITCH ARE AVAILABLE THROUGH A ROLAND V-40HD SWITCHER. THE SWITCHER CAN ACCOMMODATE UP TO 4 INPUTS.

HDMI AND ETHERNET DRIVE LINES FOR VIDEO FROM BOOTH ARE LOCATED STAGE LEFT, STAGE RIGHT AND IN THE BOOTH. A LIMITED SUPPLY OF ADAPTERS OF ALL TYPES ARE AVAILABLE IN HOUSE TO INTERFACE CONTENT DEVICES. HOWEVER, THE TECHNICIANS PREFER ALL DEVICES SUPPLIED BY CLIENTS TO BE HDMI.

THE SYSTEM DOES HAVE THE ABILITY TO OUTPUT CONTENT NOT ONLY FROM THE PROJECTOR BUT TO CLIENT PROVIDED EXTERNAL DEVICES. OUTPUTS ARE LOCATED STAGE LEFT AND STAGE RIGHT.

TWO DENON DN-500BD BLU RAY PLAYERS AND ONE YAMAHA BO-A1040 BLU RAY PLAYER ARE AVAILABLE TO PLAY CONTENT. BOTH DEVICES PLAY DVDS AS WELL. A REGION FREE DVD PLAYER IS AVAILABLE UPON REQUEST.

THE PAC DOES NOT HAVE LAPTOPS OR COMPUTERS AVAILABLE TO RUN YOUR CONTENT. YOU MUST SUPPLY THOSE DEVICES.

PLURA DUAL HD LED 10" PREVIEW MONITORS ARE IN THE VIDEO RACK IN BOOTH.

ISOLATED AUDIO OUTPUTS FROM ALL PLAYBACK IN BOOTH OR ON-STAGE

AUDIO SOUND SYSTEM

House Console(s): (1) Yamaha PM5d-RH 56 Channel Digital console with Two Yamaha PW800 Power Supply Units.

(1) MIDAS PRO 2C 56 CHANNEL DIGITAL CONSOLE WITH MIDAS DL251 DIGITAL ENGINE.

HOUSE L&R MAINS EQ: (1) KLARK-TEKNIK DN-360 31 BAND GRAPHIC EQUALIZER OPTION AVAILABLE

HOUSE CENTER & SUB EQ: ON CONSOLE AUX FEEDS 1 & 2 WITH (1) ASHLEY GQ-231 GEQ EA.

HOUSE LIMITING & CROSSOVER: ASHLEY PROTEA 4.24C ON L, R & SUBS ONLY (CROSS-OVER @102 HZ & 1.2K HZ, TIME ALIGNED TO SUBS).

NOTE: CENTER SPEAKERS USE CROWN P.I.P-AMC B-CARDS PASSIVE – ORIGINAL TO FACILITY

HOUSE AMPLIFIERS: (4) CROWN MACROTECH 24x6 (L, C, R), (1) CROWN MACROTECH 3600 (SUBS); (3) CREST CA-12 (STAGE MONITORS & MISC.)

HOUSE SPEAKERS: TWO PAS DUAL 15" FRONT LOADED/PORTED CABINET WITH EV DH1A-16 COMPRESSION DRIVER ON A CONSTANT DIRECTIVITY HORN. SPEAKER LOCATIONS ARE HOUSE RIGHT, HOUSE CENTER, AND HOUSE LEFT @ 15' ELEVATION, 20 DEGREE BEVEL. EAW SB250 SUBS LOCATED STAGE LEVEL, LEFT & RIGHT. HOUSE SYSTEM CAPABLE OF +102DB AT MIX POSITION.

ON-STAGE MIC INPUTS AND SNAKES:

- SIXTEEN (16) XLR INPUTS TO BOOTH FROM STAGE LEFT.
- TWENTY (20) XLR INPUTS TO BOOTH FROM STAGE RIGHT
- **FIFTY-SIX (56) CHANNEL XLR 3 WAY SPLITTER BOX WITH LEADS AVAILABLE UPON REQUEST**

HOUSE AUDIO COURTESY SNAKES: THERE IS ONE (1) 56 CHANNEL WHIRLWIND W4, AND ONE (1) 4 PAIR CAT 5 DIGITAL SNAKE AVAILABLE. BOTH TERMINATE STAGE LEFT WITH PLENTY OF LEAD FOR MONITOR POSITIONS AND FOH MIX POSITIONS.

ASSORTED MULTI-CHANNEL SUB-SNAKES AVAILABLE FOR ON-STAGE NEEDS.

AUDIO FEEDS TO SOUND AND VIDEO COMPANIES AVAILABLE AND ONLY UPON ADVANCED REQUEST

FLOOR MONITORS: TWO (2) CUSTOM 600 WATT RMS 3-WAY STAGE MONITORS/SIDE FILLS FOR PLAYBACK ONLY (NOT LIVE/VOCAL OR DRUM MONITORS); TWO (2) JBL STX 835 DUAL 15" SLOT-LOADED THREE-WAY PREMIUM PASSIVE 1600WATT SPEAKERS FOR SIDE FILLS; FOUR MARTIN AUDIO LE12J FLOOR MONITORS FOR GUEST ARTIST USE ONLY. FOUR SEPARATE MONITOR MIXES POSSIBLE FROM HOUSE CONSOLE, WITH NOTICE: TWO FROM SL, TWO FROM SR. NO DRUM MONITOR OR FRONT FILL ADDITIONAL SPEAKERS AVAILABLE IN-HOUSE.

PATCHBAY: WIRED THRU FULL PATCHBAY SYSTEM WITH: ALL CONSOLE CHANNELS & SNAKE LINES ½ OR FULL NORMAL & ROUTABLE; 8CH 3WAY ISOLATION SPLITTERS. ALL CHANNEL INSERTS, MAINS & MIX INSERTS ON PATCHBAY; ALL EFFECT PROCESSORS, PLAYBACK & RECORD IN PATCHBAY EASILY. PLAYBACK CHANNEL & PROCESSOR MAINS TO AMPS ONLY ARE NOT RECONFIGURABLE FOR CROSSOVER SLOPES.

FIRE ALARM SYSTEM: PARTICULATE AND IR SENSOR. SYSTEM TIED INTO HOUSE SPEAKER SYSTEM THRU ELECTRIC SHUNT WHICH DISABLES HOUSE AMPLIFIERS ONLY WHEN ALARM IS TRIPPED. FIRE-WATCH REQUIRED. **SMOKE AND HAZE USE MUST HAVE PRIOR ARRANGEMENTS WITH US BEFORE USE.**

INTERCOM SYSTEM

1 CLEAR-COM BASE STATION, **SINGLE CHANNEL HARDWIRE** WITH RS501, RS601 & RS 701 BELT PACKS AND CC300, CC400, CC26 HEADSETS. **PRIVATE 2 CHANNEL COM LIMITED BUT AVAIL ON REQUEST.**

STANDARD HOUSE DROPS AT LIGHTS, SOUND, STAGE LEFT, STAGE RIGHT, STAGE MANAGEMENT, VIDEO, SPOTS & FLY'S

STAGE PROGRAM IS SENT TO ALL BACKSTAGE AREAS VIA IR OVER-STAGE MIC. PROGRAM TO INTERCOM AVAILABLE UPON REQUEST.

1 HME Pro850 DIGITAL WIRELESS INTERCOM 2-CH. 5 BELT PACKS TOTAL, UP TO 2 PACKS AVAIL FOR GUEST ARTIST / TOUR NEEDS ONLY UPON REQUEST

BACKSTAGE PAGING CAPABILITY: YES, METHOD DESIRED UPON REQUEST. AVAILABLE FROM STAGE MANAGER'S DESK BACKSTAGE, PRODUCTION BOOTH OR VIA HME INTERCOM SYSTEM.

INTERCOM BASE-STATIONS LOCATED IN BOOTH. NOT MOVABLE

INTERCOM FLASHER UNITS AND TELEPHONE SQUAWK BOXES AVAILABLE.

RACK & PROCESSING EQUIPMENT

Manufacturer	Outboard processing/ Playback / Effects	Quantity		
Ashely	Ashely MX20 Stereo Line mixer	1		Outboard
Ashely	Ashley Graphic EQ 231	2		Outboard
Ashely	Ashley Graphic EQ X 3201	2		Outboard
Ashely	Ashley Protea 4.24C	2		Outboard
dbx	dbx 160A	1		Outboard
dbx	dbx 166A	3		Outboard
dbx	dbx160X	2		Outboard
dbx	dbx166X	2		Outboard
Denon	Denon 585 Cassette Deck dual	2		Playback
Denon	Denon C 640 CD Player (network)	1		Playback
Denon	Denon C620 CD player	3		Playback
Denon	Denon DA20 MKII DAT Recorder	1		Playback
Denon	Denon F650 Hotkeys	1		Playback
Denon	Denon F650-R Recorder	1		Playback
Denon	Denon M2000 MD recorder	1		Playback
Denon	Denon MD1050	1		Playback
Goldline	Goldline RTA	1		
Klark Teknik	Klark Teknik DB410 quad EQ	1		Outboard
Klark Teknik	Klark Teknik DN360	3		Outboard
Lexicon	Lexicon PCM91 Reverb Effect Unit	1		Effects
NUMARK	NUMARK IDEC	1		Playback
	RF Frequency Scanner tablet & system	1		
Tascam	Tascam CD-01U CD player	2		Playback
Tascam	Tascam SS-CDR200 Recorder / player / Hard Drive	1		Playback
TC Electronics	TC Electronics M-One	2		Effects
William Sound	William Sound IR Transmitter	1		
Yamaha	Yamaha SPX 90	1		Effects
Yamaha	Yamaha SPX990	1		Effects

HOUSE MICROPHONE INVENTORY

Manufacturer	Microphone / DI Type, Model Number	Quantity		
AKG	AKG C-414 B/TLII (Matched Pair)	2 Pair		
AKG	AKG C535-EB	2		
AKG	AKG D-112	1		
Audio Technica	Audio Technica 8531 Power pack	6		
Audio Technica	Audio Technica AT-4041	4		
Audio Technica	Audio Technica AT-410-A Shock Mount	4		
Audio Technica	Audio Technica AT-853 X Hanging Mic	2		
Audio Technica	Audio Technica AT857 Podium Mic	4		
Audio Technica	Audio Technica ATM 350 clip Mic	5		
Audix	Audix D2	3		
Audix	Audix D4	1		
Audix	Audix D6	1		
Audix	Audix D-CLIP	5		
Countryman	Countryman B3 Lav Mic capsules	4		
Countryman	Countryman E2 Earsets	3		
Countryman	Countryman E6 Headset / capsules	6		
CROWN	Crown PCC 160 FLOOR mic	1		
Radial	DI Radial J48 Direct Box	3		
Radial	DI Radial JPC PC DI boxes	8		
Radial	DI Radial ProD2	2		
Whirlwind	DI Whirlwind Director Boxes	2		
Whirlwind	DI Whirlwind IMP2 Direct Boxes	2		
DPA	dpa - D-vote instrument / piano mics	2		
Earthworks	Earth Works M30 - Omni Mic	1		
EV	EV RE-20	1		
Neuman	Neuman Stereo Hanging Microphone USM691	1		
Radial	Radial USB - Direct Box	3		
Senneiser	Senneiser SK2000 beltpacks XP	4		
Senneiser	Sennheiser 2000 Series dual Wireless receivers	3		
Senneiser	Sennheiser 421-M	5		
Senneiser	Sennheiser E602	1		
Senneiser	Sennheiser E604	4		
Senneiser	Sennheiser E904	4		
Senneiser	Sennheiser e965 heads	6		
Senneiser	Sennheiser K6 Power Supply	6		
Senneiser	Sennheiser ME64 Shotgun Capsule	4		
Senneiser	Sennheiser ME66 Shotgun Capsule	3		
Senneiser	Sennheiser ME67 Shotgun Capsule	4		
Senneiser	Sennheiser SKM2000 HH w/ KK204 heads	6		
Senneiser	Sennheiser SKP box transmitters	4		
Senneiser	Sennhesier E614	2		

HOUSE MICROPHONE INVENTORY “CONTINUED”

Manufacturer	Microphone / DI Type, Model Number	Quantity		
Shure	Shure Beta 52	1		
Shure	Shure Beta 57	5		
Shure	Shure Beta 58A	12		
Shure	Shure Beta 87	4		
Shure	Shure Beta 91 drum	2		
Shure	Shure Beta 98 & 98H	8		
Shure	Shure SM 58	2		
Shure	Shure SM 57	5		
Shure	Shure SM 81	2		
Shure	<i>Shure UHF Dual RF Recievers, UR series 638 - 698mHz</i>	2		
Shure	<i>Shure UR1 Transmitter Belt Packs 638 - 698mHz</i>	4		
Shure	<i>Shure UR2 Beta 58 Transmitters 638 - 698mHz</i>	4		
Shure	<i>Shure UR2 Beta 87A Transmitters 638 - 698mHz</i>	2		

HOUSE MICROPHONE STAND INVENTORY

Manufacturer	Microphone and Instrument Stands	Quantity		
K & M	KM210/9 Tripod Boom Microphone Stands	25		
Atlas	ATLAS round base Straight Microphone Stands	4		
K & M	KM231 Table top tripod Microphone Stands	8		
Audio Technica	AT 8410 Shock Mounts	5		
K & M	K&M 259 Short tripod stands	12		
	Studio Rover Stands	2		
K & M	K&M 259500 short tripod	3		

DRESSING ROOMS & GREENROOMS

BACKSTAGE 2ND FLOOR (TELEPHONES AVAILABLE IN ALL ROOMS; PHONE NUMBER BY REQUEST)

- **WOMEN'S / CHORUS DRESSING ROOM A:** TWENTY STATIONS WITH MIRRORS, LIGHTS, ELECTRIC OUTLETS AND WARDROBE RACKS; TWO BATHROOMS WITH SHOWERS
- **MEN'S / CHORUS DRESSING ROOM B:** TWENTY STATIONS WITH MIRRORS, LIGHTS, ELECTRIC OUTLETS AND WARDROBE RACKS; TWO BATHROOMS WITH SHOWERS
- **GREENROOM #2:** TEN STATIONS WITH MIRRORS AND LIGHTS; NO BATHS; CARPETED WITH 2 WARDROBE RACKS; CATV DROP & PHONE SERVICE. TABLES & SEATING.
- **2ND FLOOR ACCESS** BY STAIRWELL ONLY. NO ELEVATORS AVAILABLE.

BACKSTAGE 1ST FLOOR (TELEPHONES AVAILABLE IN GREENROOM; PHONE NUMBER BY REQUEST)

- **STAR DRESSING / GREENROOM #1:** EIGHT MAKE UP STATIONS, WITH MIRRORS AND LIGHTS; TWO 1/2 BATH RESTROOMS ADJACENT IN HALLWAY (NOT PRIVATE); PRACTICE UPRIGHT PIANO (TUNINGS-REQUEST IN ADVANCE); CARPETED WITH SOFA'S & LOUNGE; 2 WARDROBE RACKS; CATV DROP & TV.
- **CENTER HALL CORRIDOR:** TILED AREA, MAY BE PARTIALLY COVERED WITH MARLEY FLOOR FOR PERFORMER CROSS-OVER DURING DANCE; ADDITIONAL WORK SPACE, CATERING LAYOUT, WARM-UP AREA, AND/OR ROAD CASE STORAGE
- **CENTER HALL STORAGE ROOM:** WASHER AND DRYER FACILITIES; SEWING & HOUSE STORAGE AREA; LIMITED SPACE AVAILABLE AS IT IS THE VENUES STORAGE AREA.

PRODUCTION TOUR MANAGER OFFICE

- 1ST FLOOR LOCATION--ADJACENT TO "STAR" GREENROOM
- TELEPHONE LINE (NUMBER AVAILABLE BY REQUEST AFTER CONTRACT ISSUED)
- LOCKING COMBINATION SAFE (AVAILABLE USE UPON REQUEST)
- DESK & CHAIR
- WI-FI THRU-OUT BUILDING (OPEN PORTAL)
- PHOTO-COPIER / SCANNER AVAILABLE IN TECH OFFICE
- FAX AVAILABLE IN LOBBY BUSINESS OFFICE

MISC. AMENITIES AVAILABLE (FOR GUEST ARTIST SERIES USE ONLY)

- IRON & IRONING BOARDS; CLOTHES STEAMERS; MIRRORS; SEWING STATION;
- MINI-FRIDGE; ICE BUCKETS & COOLERS; ICE MACHINE (IN LOBBY KITCHEN);
- FACE & BATH TOWELS
- SOAP, DETERGENT AND CLEANING PRODUCTS LIMITED IN HOUSE—BRING YOUR OWN.
- FULL COFFEE & TEA SERVICES WITH NOTICE
- FULL CATERING SERVICE WITH NOTICE
- WASHER/DRYER;
- TABLES/CHAIRS/LAMPS;
- MICROWAVE
- WI-FI AVAILABLE THROUGHOUT THE ENTIRE VENUE (OPEN PORTAL)
- BROOMS, MOPS, VACUUM ETC.
- GAS MIG-WELDER & SOME STEEL IN HOUSE FOR MINOR REPAIRS
- FIRE CABINET USE & STORAGE; MSDS
- MISC HARDWARE, STEEL & RIGGING STOCK LIMITED
- ELECTRICAL REPAIR BENCH ABILITY & CARPENTRY SHOP TOOLS & HAND TOOLS
- AIR COMPRESSOR, HOSES & AIR TOOLS

NOTE: THE VENUE HAS NO VENDING MACHINES ON PREMISES. ONLY WATER FOUNTAINS.

NOTE: THE ROCKVILLE CAMPUS IS A TOBACCO-FREE CAMPUS. TOBACCO USE IS ONLY PERMITTED OFF-CAMPUS. THERE IS NO SMOKING PERMITTED ANYWHERE IN THE VENUE OR IMMEDIATELY OUTSIDE THE VENUE.

FINAL NOTES & BASIC HOUSE RULES

-NO PYROTECHNICS - PERIOD, NOT WITHOUT ADVANCED WRITTEN NOTICE & APPROVAL: NO OPEN FIRE, FLAMES, OIL LAMPS OR GAS TORCHES. NO ATMOSPHERIC SPECIAL EFFECTS PERMITTED WITHOUT NOTICE AND PRIOR APPROVAL FROM VENUE STAFF TO SECURE FIRE ALARM SYSTEM & SAFETY WATCH.

-NO CONFETTI, MYLAR OR SNOW EFFECTS, NO RAIN, BLOOD, LIQUID, OIL OR WATER EFFECTS ON-STAGE WITHOUT PRIOR APPROVAL OF METHODS & MATERIALS; NO “MESSY” ACTS OR EFFECTS (E.G. FRUIT SMASHING), NO ANIMAL ACTS OR ANIMALS ON STAGE, NO AEROSOL TOYS, WATER CANNONS OR SPRAYING OF AUDIENCE. SERVICE ANIMALS ALLOWED.

-CHILDREN **MUST BE SUPERVISED AND CHAPERONED AT ALL TIMES.** AREAS WILL BE DESIGNATED AS OFF-LIMITS AND FOR CHILDREN ONLY. NO RUNNING, JUMPING OR OTHER UNPROFESSIONAL BEHAVIOR PERMITTED.

-ALL DROPS AND SETS ETC MUST BE SAFE, USING SAFE RATED HARDWARE AND ALSO MUST HAVE CURRENT FLAME CERTIFICATES &/OR PASS FLAME TESTS AT OUR DISCRETION—OR THEY DO NOT HAPPEN OR HANG ON OUR STAGE. SO BE READY--OR BE READY TO DEAL WITHOUT IT. NO MOVING OF HOUSE SOFT-GOODS WITHOUT SUPERVISION OR APPROVAL.

-NO AUTOMOBILES, ELECTRIC CARS, MOTOR BIKES OR SIMILAR ON STAGE; NO ELECTRICAL, MECHANICAL OR HYDRAULIC MACHINES OR LIFTS ON STAGE WITHOUT APPROVAL.

-NO WEAPONS (INCLUDING MARTIAL ARTS) OR STAGE/PROP BLANK-GUNS ON STAGE OR IN FACILITY WITHOUT PRIOR APPROVAL & SAFETY ARRANGEMENTS IN PLACE; NO PHYSICAL GRID DROPS; NO DRILLING INTO OUR DECK OR WALLS WITHOUT ADVANCED APPROVAL.

-REHEARSAL SPACE, INSTRUMENTS, BACKLINE OR STUDIO NEEDS MUST BE SUBMITTED IN ADVANCE VIA CONTRACT. RIDERS MUST BE SUBMITTED 30 DAYS IN ADVANCE.

-ANY AND ALL INTERFACE WITH HOUSE EQUIPMENT AND YOUR EQUIPMENT MUST BE APPROVED PRIOR—AND YOU MUST BE PREPARED TO PROVIDE FOR ALL ADAPTORS OR INTERFACES AND CABLES YOU MAY NEED.

-ANY AND ALL ITEMS FOR RIGGING OR FLY SYSTEM USE INCLUDING DROPS, HARD OR SOFT SET PIECES, SOLENOIDS/KABUKI ETC, MUST BE NOTIFIED, INSPECTED AND WEIGHT AMOUNTS PROVIDED PRIOR TO LOAD-IN. SUBMISSION OF TOUR LINE-SET SCHEDULE & CHANGES PREFERRED. “HOMEMADE” ITEMS IN RIGGING ITEMS OVERHEAD SUCH AS PULL WIRES & PINS, RUBBER BANDS, MOUSE TRAPS, CLOTHES HANGERS ETC WILL NOT BE PERMITTED. **NO ‘FLYING’ OF PEOPLE FROM THE HOUSE COUNTERWEIGHT SYSTEM PERMITTED.**

-ALL RIGGING METHODS & EQUIPMENT SUBJECT TO INSPECTION & APPROVAL; HOUSE STAFF MAY RELOCATE LINE-SET REQUESTS TO WITHIN 4 LINE-SETS (24 INCHES) US OR DS OF DESIRED LOCATION SPACE, IF HOUSE STAFF DEEM SUCH NECESSARY FOR ANY REASON.

-NO AERIAL ACTS, SWINGS, TRAPEZE, SILKS, CABLE OR OTHER AERIAL STUNTS PERMITTED ON STAGE, WHETHER RIGGED FROM FLY SYSTEM OR GRID. THE "FLYING" OF PERSONS IS STRICTLY PROHIBITED. FLYING EFFECTS MAY ONLY BE CONSIDERED FOR PERMISSION ON RATED & APPROVED RIGS WITH KNOWN & APPROVED COMPANIES (E.G. FOY, ZFX) & WITH ALL PROPER LIABILITIES IN PLACE & TRAINED OPERATORS ON-SITE AND IN FULL OPERATION.

-HOUSE TECHNICAL STAFF HAVE FINAL DETERMINATION AND ALL AUTHORITY FOR SAFETY, SECURITY, ACCESS, OPERATION AND LIABILITY ISSUES, AS WELL AS ALL ACCESS CONTROL BACKSTAGE, REGARDLESS OF SHOW OR ARTIST.

UNDER NO CIRCUMSTANCES WILL KEYS FOR ANY AREA IN THE ROBERT E. PARILLA PERFORMING ARTS CENTER BE PROVIDED TO ARTIST(S) OR AGENT(S) POSSESSION WITHOUT PRIOR SPECIAL ARRANGEMENTS & PROVISIONS. STAGE SECURITY AVAILABLE W/ NOTICE.

ACCESS TO SECURED DRESSING ROOM AREAS WILL BE GRANTED TO ARTIST(S) UPON REQUEST MADE TO THE THEATRE PRODUCTION TECHNICIAN DESIGNATED AS LIAISON BETWEEN ARTIST(S) AND CENTER.
NO PROPPING OPEN OF DOORS OR WINDOWS PERMITTED.

CONTACT VENUE PRODUCTION STAFF WITH ANY TECHNICAL QUESTIONS OR NEEDS.

Performing Arts Center; House RF Frequencies-in-use:

<u>*Shure UHF-R Model Wireless mics:</u>	<u>Tx/Rx POWER:</u> 10mW-50mW ; user set variable:	641.725MHz; 651.050MHz; 642.350MHz; 645.950MHz	This equipment operates in the Shure L3 frequency range; 638MHz-698MHz
<u>Wireless Intercom; HME PRO850 system (current fixed frequencies):</u>	<u>Tx/Rx POWER:</u> 1mW-50mW autosensing:	Base: 521.250MHz / 520.500MHz; Beltpacks: 651.500MHz; 656.500MHz; 666.750MHz; 655.375MHz	
<u>Motorola Walkie/Radio system (fixed frequencies):</u>	<u>Tx/Rx POWER:</u> 2W (fixed):	VHF 130-170MHz range; UHF 403-495MHz range.	<u>House Wi-Fi connection:</u> 2.4GHz – 2.8GHz

****NOTE: Asterisk signifies that specific RF system may or may not be required for show operation and may be discounted, re-tuned or turned off upon request if not used. Systems without an asterisk are considered required for all in-house & show operation, and you should expect those frequencies to be in-use and unavailable.***

Over 10 Motorola Radios tuned and possible in use during show by house, security and stage management—specific frequencies per radio are not available.

The listed frequencies here are to aid any tour/company who will bring in their own wireless systems to use, so they may tune around or plan for adjustments that must be made.

Per new FCC compliances and any future laws or changes to FCC policy- any user groups bringing in their own wireless are responsible for planning, licenses, tuning & handling their own RF issues as may be required; for registering their system / use plans, frequencies and dates of use in this area with any FCC database prior or as required to use to avoid penalty fines. As per FCC regulations, no guarantee is made for interference free use and FCC laws may change. User group / RF equipment owner & operator is liable and responsible for any and all fines or penalties or misuse of frequencies or interferences. Any illegal 700MHz equipment will not be permitted to operate in the Center at any time.