

Rockville Campus – Robert Parilla Performing Arts Center
Asbestos Survey map June 1991

Only some of the floor tile is ACM. Floor tile mastic is not ACM

Errata: Sample 3-RPAC is not positive.

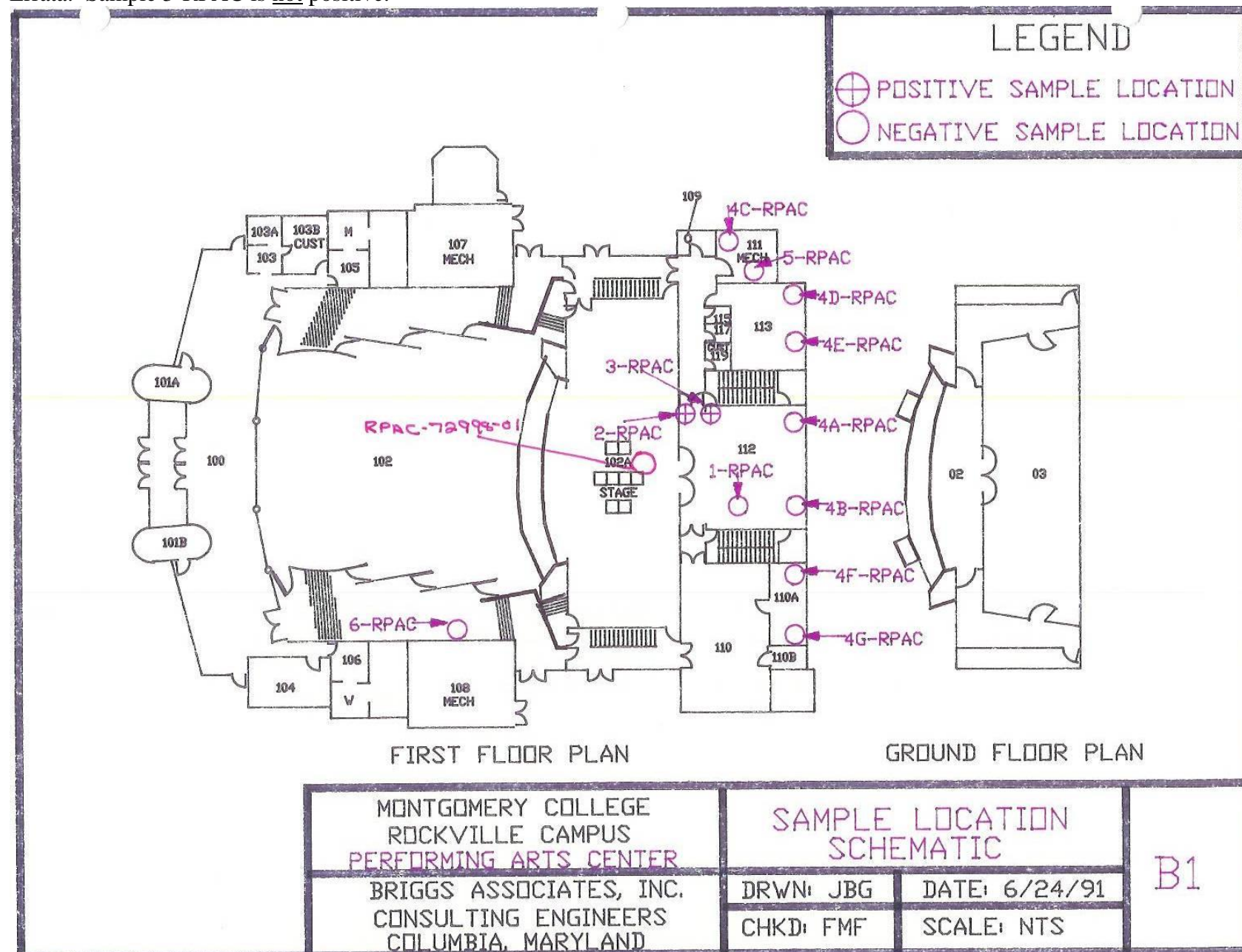

LEGEND



ASBESTOS CONTAINING
FLOOR TILE

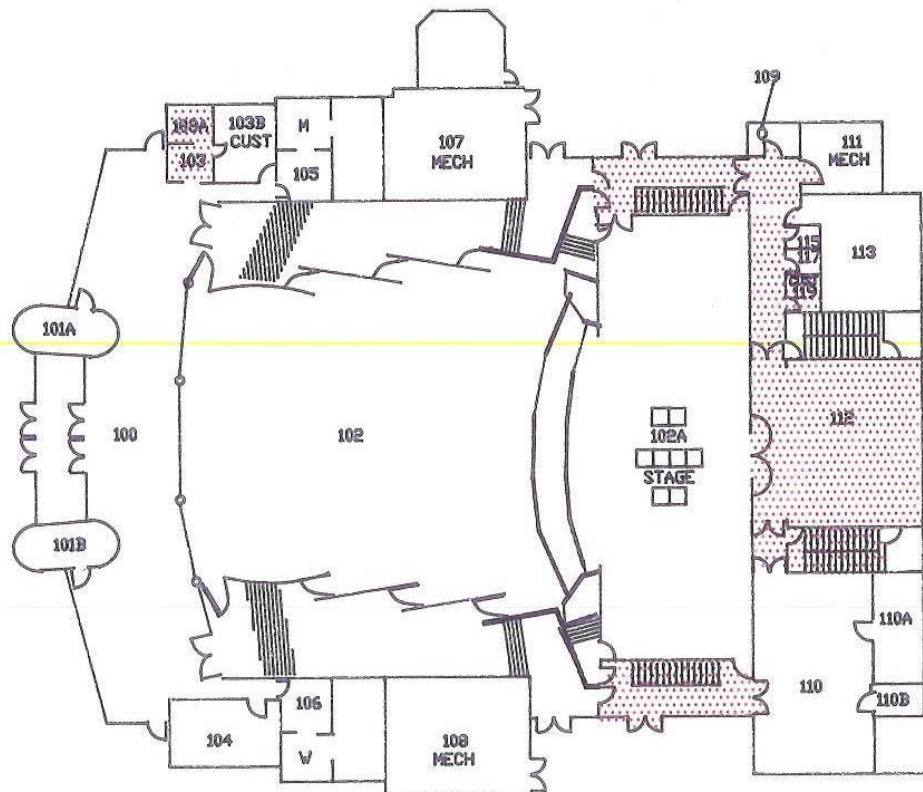

FIRST FLOOR PLAN

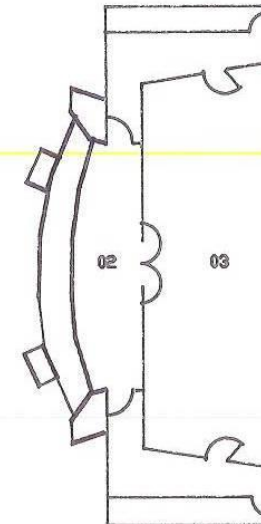

GROUND FLOOR PLAN

MONTGOMERY COLLEGE
ROCKVILLE CAMPUS
PERFORMING ARTS CENTER

BRIGGS ASSOCIATES, INC.
CONSULTING ENGINEERS
COLUMBIA, MARYLAND

ASBESTOS CONTAINING
MATERIALS LOCATION
SCHEMATIC

DRWN: JBG

DATE: 6/24/91

CHKD: FMF

SCALE: NTS

B2

LEGEND
 ASBESTOS CONTAINING
 FLOOR TILE

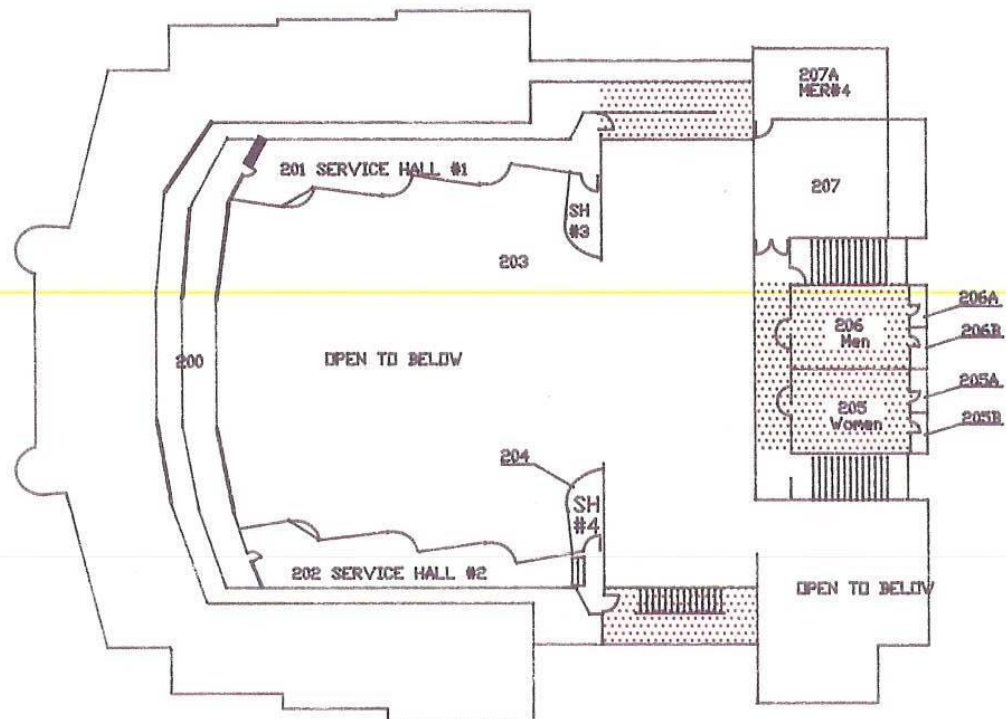

MONTGOMERY COLLEGE
 ROCKVILLE CAMPUS
 PERFORMING ARTS CENTER

BRIGGS ASSOCIATES, INC.
 CONSULTING ENGINEERS
 COLUMBIA, MARYLAND

ASBESTOS CONTAINING
 MATERIALS LOCATION
 SCHEMATIC

DRWN: JBG

CHKD: FMF

DATE: 6/24/91

SCALE: NTS

B3